



solidxperts

WHAT'S NEW

TOOLSXPERTS 2025



Table des matières

BeamCutXperts.....	2
Multiple raw lengths	2
Automatic drawings creation.....	2
Display of the part with all its bodies	2
Bend notes format control	3
Lists Manager	4
Drawings selection.....	4
Quantity Report.....	5
Line merge criteria.....	5
SaveXperts	5
Improved PDF performance	5
TasksXperts	6
Setting the description property name.....	6

BeamCutXperts

Multiple raw lengths

It is now possible to specify multiple lengths when defining a raw beam in the database. During the analysis, all lengths are used in different optimization scenarios. The final scenario selected is the one with the least loss.

Automatic drawings creation

Display of the part with all its bodies

A new option allows to obtain a drawing (or sheet, depending on the options checked) showing all the bodies of the part when creating the views. For example, in the case where each body of the part must be displayed in a separate sheet, the first sheet will display the entire part with all its bodies.

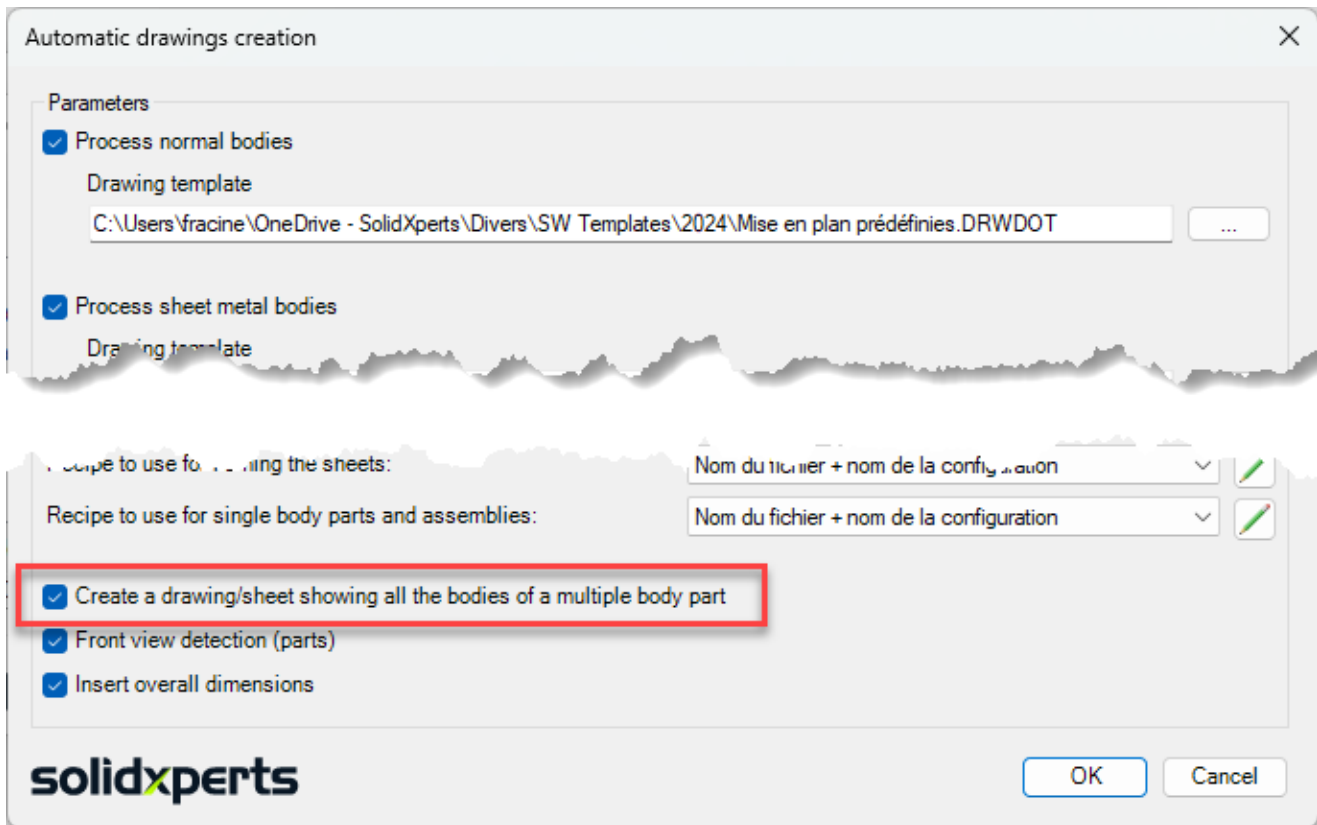

Bend notes format control

It is now possible to control the format of bend notes. The Solidxperts option mirrors the SOLIDWORKS option:

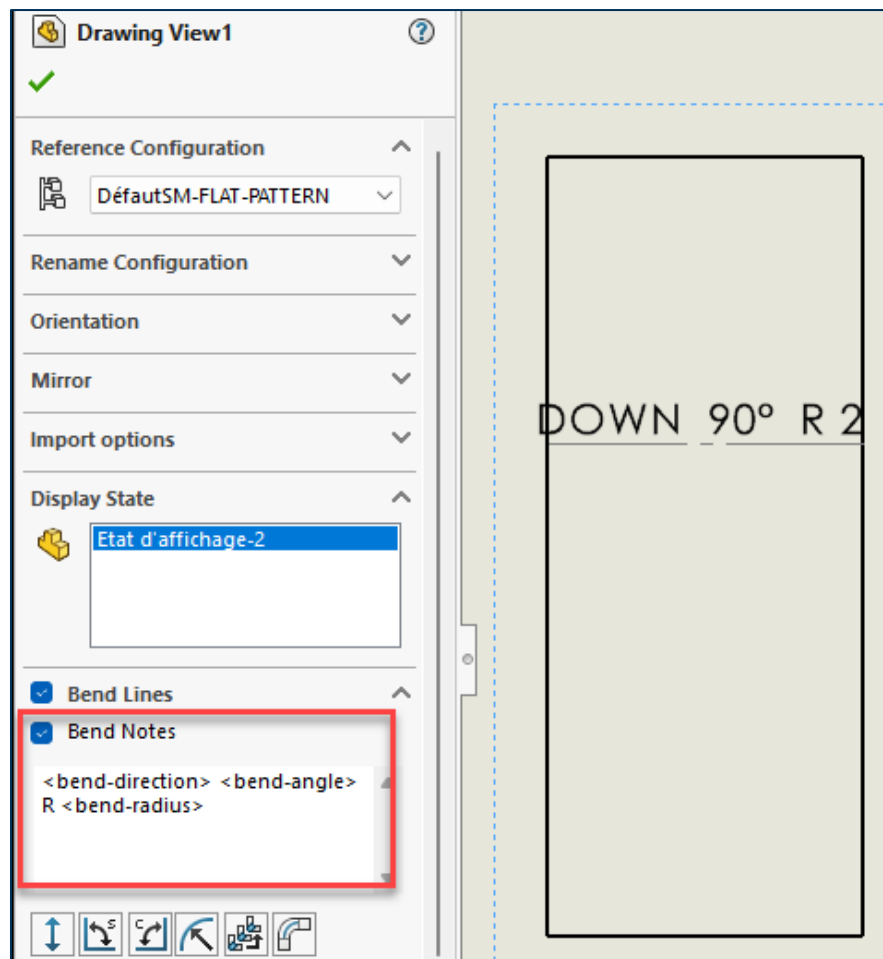

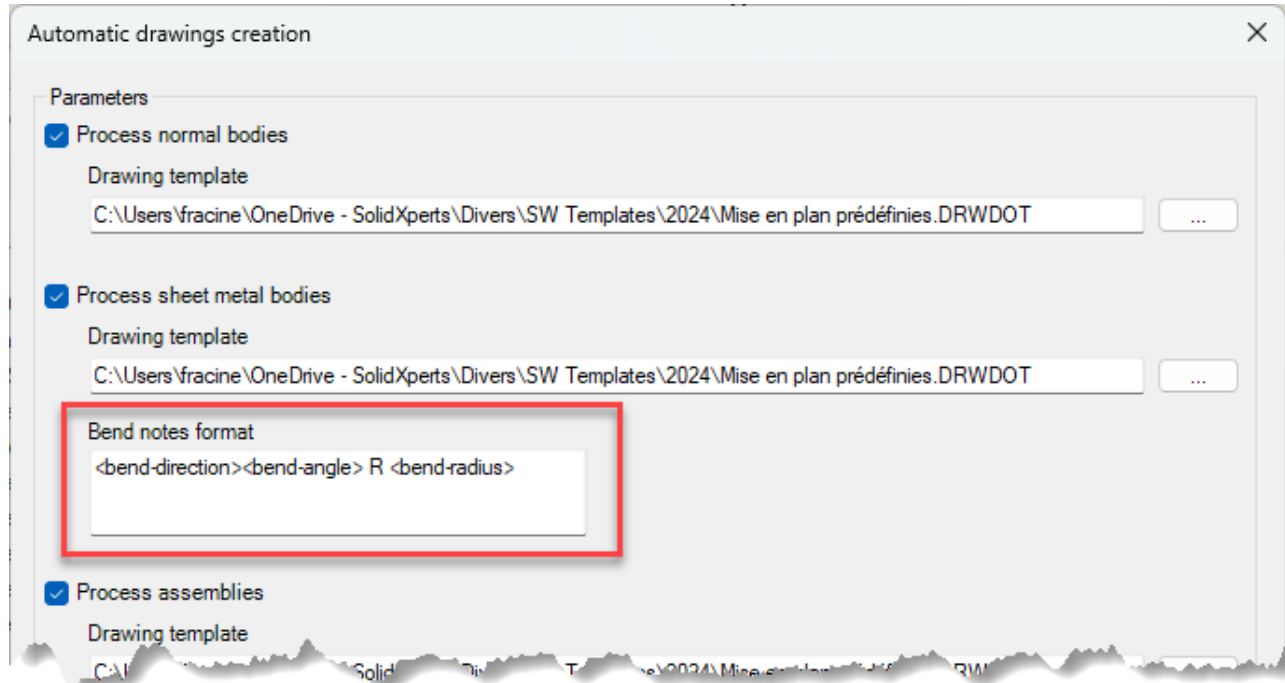

Lists Manager

Drawings selection

A new option has been added to the following window, which allows importing items from a list to the main application (eg SaveXperts, PrintXperts, etc.):

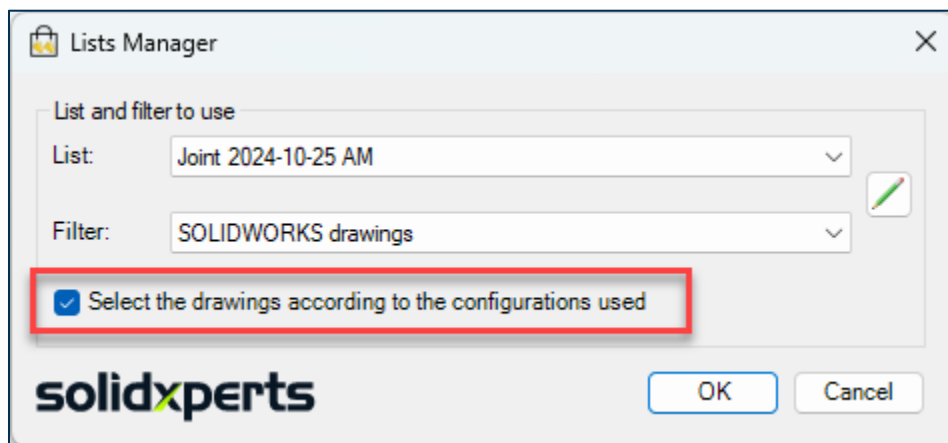

When this option is checked, an analysis of the 3D files is made and only the drawings that use the project's configuration are imported into the main application.

Quantity Report

Line merge criteria

It is now possible to specify multiple conditions for merging lines. See details in the Quantity Report configuration file :

```
#The IDENTIFIER provides a way to avoid getting more than one row for what c
#item. By default, the tool will create multiple report rows when different C
#are used in the assembly. When using the IDENTIFIER parameter, items that hav
#The possible values for the IDENTIFIER are:
#   - Name of a custom property
#   - $PARTNUMBER
#   - $FILENAME
#This parameter is OPTIONAL.
#If multiple values are specified, use a pipe (|) between each value.
#Example: IDENTIFIER = Description | $FILENAME | PartNo
IDENTIFIER =
```

Note: The original Quantity Report file is the *Options.ini* file located in the folder *C:\Program Files\SolidXperts\Quantity Report*.

SaveXperts

Improved PDF performance

PDF export time in cases where each sheet needs to be placed in a separate PDF has been greatly improved.

TasksXperts

Setting the description property name

With previous versions of ToolsXperts, when copying body properties (sheet metal or weldment), the Description property was not copied in order not to overwrite the property of the same name located at the document (or configuration) level. It is now possible to enable copying and set the name of the destination property.

